

Low pressure sensors with connection head

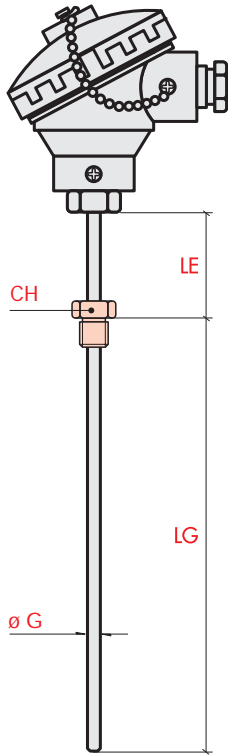

Electrical connection



Mounting Fittings (For models without fixed attaching device only)

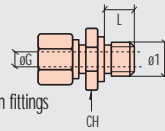

Suggested adjustable compression fittings

Material	ø1	L	CH	øG	Model
AISI 316	1/8"G	10.5	12	5	Z1 RFS-B/E050
	1/8"NPT	10.5	12	5	Z1 RFS-B/M050
	1/4"G	12	17	6	Z1 RFS-B/F060
	1/2"G	14	24	6	Z1 RFS-B/I060
	1/4"G	12	17	8	Z1 RFS-B/F080
Treated brass	1/2"G	14	24	8	Z1 RFS-B/I080
	1/4"G	12	17	6	Z1 RFS-O/F060
	1/2"G	14	24	6	Z1 RFS-O/I060
	1/4"G	12	17	8	Z1 RFS-O/F080
	1/2"G	14	24	8	Z1 RFS-O/I080

Flanges

Model	øG
Z2 FLS-A/A060	6
Z2 FLS-A/A080	8

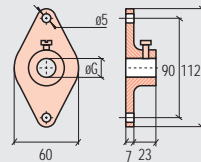

F1 Straight RTD,
5 to 8mm
sheath o.d.,
optional fixed
attaching device

Connection head	Diameter øG mm	Base code	Thermocouple type	Element N° and limits	Hot junction	Sheath material	Sheath LG mm	Type of thread	Extension LE mm
Cylindrical IP54 	5	F1 C50	L Fe - CuNi DIN/500°C max	0 Single Cl. 2 (standard)	0 Insulated 	B AISI 316	0100	S Without	00 Without
	6	F1 C60							
	8	F1 C80							
Miniat. IP67 	5	F1 M50	J Fe - CuNi IEC/500°C max	1 Dual Cl. 2 (standard)	1 Grounded 	0150	D M10 x 1.5 x L13 CH - 14 (for ø5 and ø6)	05 50	
	6	F1 M60	K NiCr - Ni DIN - IEC/800°C max	2 Single Cl. 1 (special)	2 Exposed 	0200	E 1/8" Gas - L12 CH - 14 (for ø5 and ø6)	08 80	
	8	F1 M80		3 Dual Cl. 2 (special)		0250	F 1/4" Gas - L13 CH - 17	10 100	
Standard IP67, optional transmitter * 	5	F1 S50				0300	H 3/8" Gas - L15 CH - 22		
	6	F1 S60				0350	I 1/2" Gas - L15 CH - 24		
	5 + T	F1 T50				0400	M 1/8" NPT - L10 CH - 14 (for ø5 and ø6)		
	6 + T	F1 T60				0450	N 1/4" NPT - L13 CH - 17		
EEx d IIB IP65, optional transmitter * 	8 + T	F1 T80				0500	Q 1/2" NPT - L15 CH - 24		
	6	F1 X60							
	8	F1 X80							
	6 + T	F1 U60							
	8 + T	F1 U80							
						L min 0050			

Note: * Transmitter for single element only

Note: other lengths on request for LG and LE. Code ex.: LG = 135mm Code 0135 / LE = 60mm Code 06

Reference model:

Straight thermocouple, standard head, 6mm sheath o.d., Fe-CuNi DIN, single element class 2, ungrounded junction plain end, AISI 316 sheath, 100mm length, no extension, no fixed attaching device.

F1 S60 - L 0 0 - B 0100 - S 00

□ - □ □ □ - □ □ □ - □ □ □





Certificata ISO 9002
Centro taratura SIT **JTC**

ELSI s.r.l. - via Milano, 11 - 20020 Lainate (MI)
Tel.: (02) 9370868 / 9373042 - Fax: (02) 9371724
Home page: www.elsi.it • e-mail: info@elsi.it

Low pressure sensors with connection head

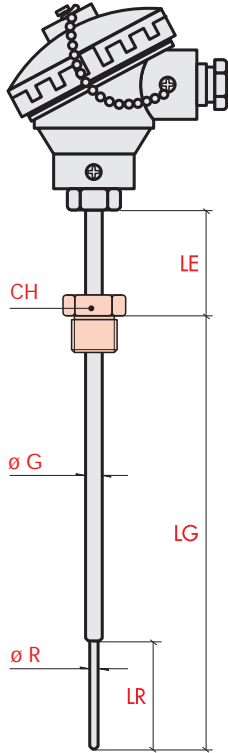
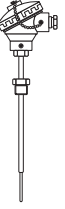

Electrical connection



Mounting Fittings

(For models without fixed attaching device only)

Suggested adjustable compression fittings

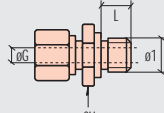

Material	ø1	L	CH	øG	Model
AISI 316	1/4"G	12	17	6	Z1 RFS-B/F060
	1/2"G	14	24	6	Z1 RFS-B/I060
	1/4"G	12	17	8	Z1 RFS-B/F080
	1/2"G	14	24	8	Z1 RFS-B/I080
Treated brass	1/4"G	12	17	6	Z1 RFS-O/F060
	1/2"G	14	24	6	Z1 RFS-O/I060
	1/4"G	12	17	8	Z1 RFS-O/F080
	1/2"G	14	24	8	Z1 RFS-O/I080

Flanges

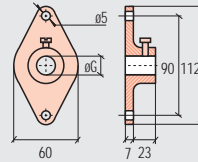

Model	øG
Z2 FLS-A/A060	6
Z2 FLS-A/A080	8

F2 Straight/tapered thermocouple, 6 and 8 mm o.d., optional fixed attaching device

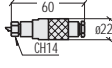
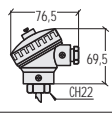
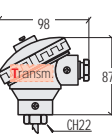
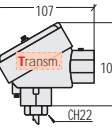
Connection head	Diameter øG mm	Base code	Thermocouple type	Element N° and limits	Hot junction	Sheath material	Sheath LG mm	Tapering øR x LR mm	Type of thread	Extension LE mm
Cylindrical IP54 	6	F2 C60	L Fe - CuNi DIN/500°C max	0 Single Cl. 2 (standard)	0 Insulated	B AISI 316	0100	0 D4 x 50	S Without	00 Without
	8	F2 C80								
Mignon 1P67 	6	F2 M60	J Fe - CuNi IEC/500°C max	1 Dual Cl. 2 (standard)	1 Insulated		0150	1 D4 x 80	D M10 x 1.5 - L13 CH - 14(ø6 only)	05 50
	8	F2 M80	K NiCr - Ni DIN-IEC/800°C max	2 Single Cl. 1 (special)	2 Grounded		0200	2 D4 x 100	E 1/8" Gas - L12 CH - 14(ø6 only)	08 80
Standard IP67, optional transmitter 	6	F2 S60		3 Dual Cl. 2 (special)	2 Exposed		0250	3 D5 x 50	F 1/4" Gas - L13 CH - 17	10 100
	8	F2 S80					0300	4 D5 x 80	H 3/8" Gas - L15 CH - 22	
	6 + T	F2 T60					0350	5 D5 x 100	I 1/2" Gas - L15 CH - 24	
	8 + T	F2 T80					0400		M 1/8" NPT - L10 CH - 14(ø6 only)	
	6	F2 X60					0450		N 1/4" NPT - L13 CH - 17	
EEx d IIB IP65, optional transmitter 	8	F2 X80					0500		Q 1/2" NPT - L15 CH - 24	
	6 + T	F2 U60								
	8 + T	F2 U80					L min 0050			

Note: * Transmitter for single element only

Note: other lengths on request for LG and LE. Code ex.: LG = 135mm Code 0135 / LE = 60mm Code 06

Reference model:

Straight/tapered thermocouple, standard head, 6mm sheath o.d., Fe-CuNi DIN, class 2 single element, ungrounded junction plain end, AISI 316 sheath, 100mm length, D4 x 50 tapering, no extension, no fixed attaching device.

F2 S60 - L 0 0 - B 0100 . 0 - S 00

□ - □ □ □ - □ □ □ . □ - □ □ □

