

Electrical connection

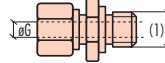

Mounting Fittings (see data sheet Z1 Accessories)  
(for models without fixed attaching device only)

NPT adjustable compression fittings



Material	Type of thread (1)	øG	Code
AISI 316	1/8" G	5	Z1 RFS-B/E050
	1/8" NPT	5	Z1 RFS-B/M050
	1/4" G	6	Z1 RFS-B/F060
	1/2" G	6	Z1 RFS-B/I060
	1/4" G	8	Z1 RFS-B/F080
Treated brass	1/2" G	8	Z1 RFS-B/I080
	1/4" G	6	Z1 RFS-O/F060
	1/2" G	6	Z1 RFS-O/I060
	1/4" G	8	Z1 RFS-O/F080
	1/2" G	8	Z1 RFS-O/I080

Flanges (see data sheet Z2 Flanges)

Code	øG
Z2 FLS-A/B060	6
Z2 FLS-A/B080	8

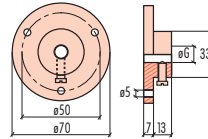

Low pressure sensors with connection head

Straight thermocouple, ø 5 to ø 10 mm sheath, optional fixed attaching device

Connection head	Diameter øG mm	Base code	Thermocouple type	Element N° and limits	Hot junction	Sheath material	Sheath LG mm	Type of thread	Extension LE mm					
DIN B IP67 optional Transmitter *	5	<b>F1 B50</b>	<b>J</b> Fe - CuNi IEC / 500°C max	<b>0</b> Single Cl. 2 (standard)	 Insulated	<b>B</b> AISI 316	<b>0100</b>	<b>S</b> None	<b>00</b> None					
	6	<b>F1 B60</b>												
	8	<b>F1 B80</b>												
	10	<b>F1 B00</b>												
	5+T	<b>F1 V50</b>	<b>K</b> NiCr - Ni DIN - IEC / 800°C max	<b>1</b> Dual Cl. 2 (standard)						 Grounded				
	6+T	<b>F1 V60</b>												
8+T	<b>F1 V80</b>													
10+T	<b>F1 V00</b>													
Mignon IP67	5	<b>F1 M50</b>	<b>L</b> Fe - CuNi DIN / 500°C max	<b>0</b> Single Cl. 2 (standard)	 Grounded	<b>B</b> AISI 316	<b>0150</b>	<b>F</b> 1/4" Gas - L13 CH-17	<b>05</b> 50					
	6	<b>F1 M60</b>												
	8	<b>F1 M80</b>												
Standard IP67 optional Transmitter *	5	<b>F1 S50</b>	<b>L</b> Fe - CuNi DIN / 500°C max	<b>0</b> Single Cl. 2 (standard)						 Grounded	<b>B</b> AISI 316	<b>0200</b>	<b>H</b> 3/8" Gas - L15 CH-22	<b>10</b> 100
	6	<b>F1 S60</b>												
	8	<b>F1 S80</b>												
	10	<b>F1 S00</b>												
	5+T	<b>F1 T50</b>												
	6+T	<b>F1 T60</b>												
	8+T	<b>F1 T80</b>												
10+T	<b>F1 T00</b>													
II 2G Ex db IIC Gb IP67 optional Transmitter *	6	<b>F1 X60</b>	<b>L</b> Fe - CuNi DIN / 500°C max	<b>0</b> Single Cl. 2 (standard)	 Grounded	<b>B</b> AISI 316	<b>0250</b>	<b>I</b> 1/2" Gas - L15 CH-24	<b>10</b> 100					
	8	<b>F1 X80</b>												
	6+T	<b>F1 U60</b>												
	8+T	<b>F1 U80</b>												
							<b>L min</b>	<b>XXXX</b>						

Note: for LG and LE other lengths upon request. Code example: LG = 135mm cod. 0135 / LE = 60mm cod. 06, \* Transmitter for single element only.

Product code example: **F1 S60 - L00 - B0100 - S00**

Straight thermocouple, standard head, ø 6mm sheath, Fe-CuNi DIN, single element class 2, ungrounded junction plain end, AISI 316 sheath, 100mm length, no extension, no fixed attaching device.